



FARAM

Reset



The Reset monoblock partition wall is characterized by a thickness of 50 mm. The partition modules are installed on a telescoping top and bottom rail that can be leveled with a fine adjustment in the range of ± 25 mm.

The patented "Fast Joint" system allows for easy installation and demounting of single modules without disturbing the adjacent ones. This demountable partition is composed of monoblock modules.



Reset is the new monoblock demountable partition by Faram. A modular structure complete with profiles, facing panels, gaskets and accessories, a constant thickness whatever the chosen finish, and an innovative joint system make Reset an easy-to-install, low-cost partition.

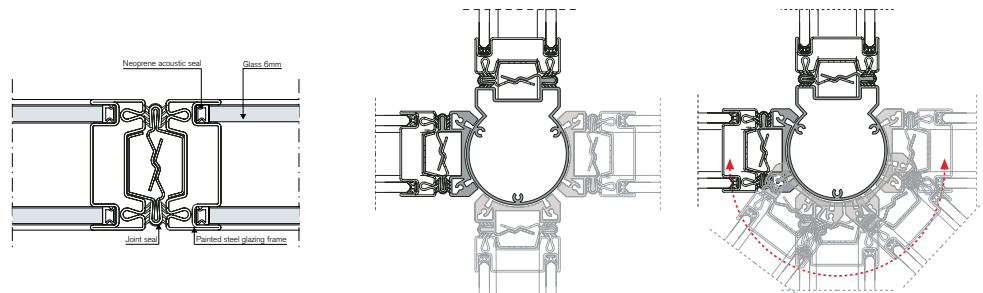



FARAM

Reset

Melamine panel: is made by assembling two outer panels 12 mm thick on the perimeter frame plus a 100 kg/mc density rock wool mat. Panels have an acoustic resistance of 31 dB.

Steel panel: the steel panel is made by assembling two shaped steel outer panels, one 1.2 mm and the other 0.9 mm thick, wood particle board 9 mm thick, plus a 100 kg/mc density rock wool mat. Panels have an acoustic resistance of 38 dB.

Single glazed panel: this glazed module comprises a frame made of extruded aluminium profiles with 8 mm thick toughened glass assembled with strips to ensure a good acoustic performance.

Double glazed panel: this glazed module comprises a frame made of rolled steel profile with one pane of 3+3+0.38 layered glass or 6 mm thick toughened glass plus a second pane of 5 mm thick toughened glass assembled with strips to ensure a good acoustic performance. Panels have an acoustic resistance of 32 dB.

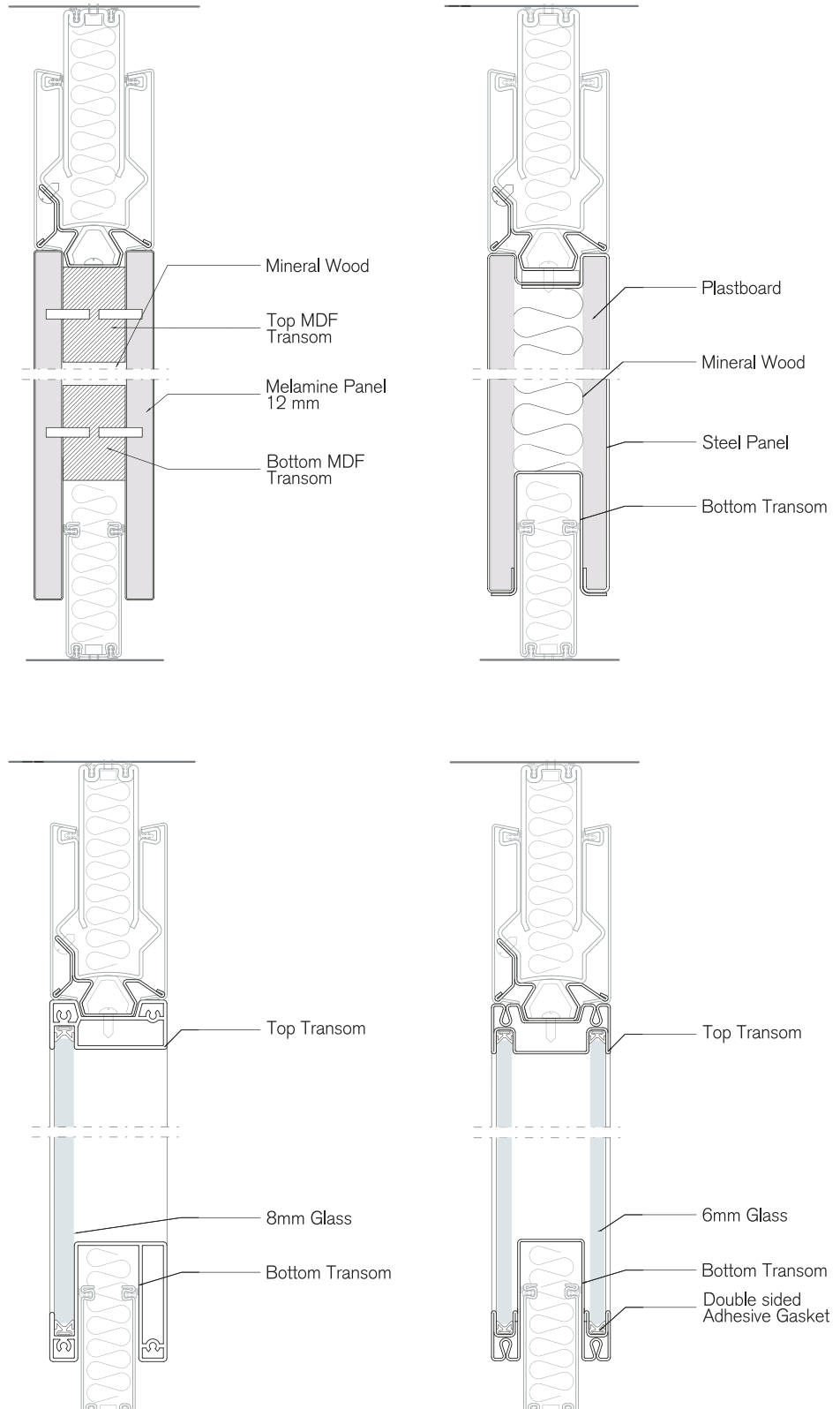



FARAM

Reset



Easy and flexible to use: the extremely rapid installation and anchoring of the modules also makes it easy to substitute a given element even after completing the works.

Corner joints: the steel profile corner joints enable the wall modules to be orientated at 90° or any other angles in 2-, 3- and 4-way configurations.

Electric wiring: the Reset project includes a special module 200 mm wide that can be hooked into each wall module for collection and transit of a considerable number of cables.



Faram can introduce modifications for the improvement of the product without prior notice. Finishes to be referred to Faram dedicated information.